

Build Your Own Bar System

Flush-Cut Straight Bars, Deluxe (Refrigerator Ready)



1. Select Desired Style:



M
Monroe



N
Nassau



R
Richmond

2. Select Desired Size & Options:

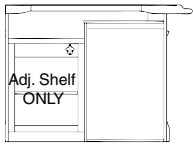

52"
 58"

OPTION: None

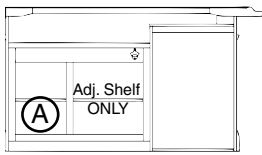

64"
 70"
 76"

OPTIONS: A Cabinet

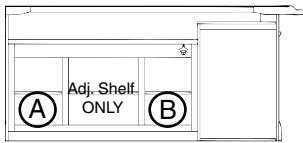

82"
 88"
 94"

OPTIONS: A & B Cabinets

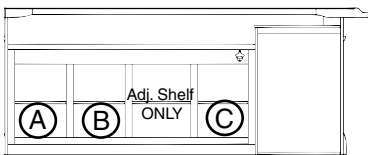

100"
 106"

OPTIONS: A, B, & C Cabinets

Cabinet Options

The line drawings to the left show letters inside circles indicating cabinet positions. If you would like one of the options shown below in the space marked with that letter, please write the letter in circle beneath pictured option. Note: Adjustable shelf is standard.

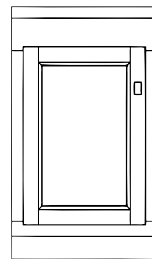

Non-Locking Door

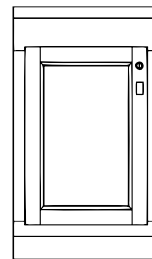
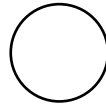

Locking Door

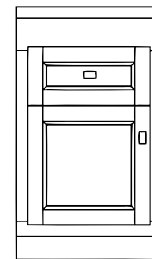
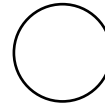

Drawer Over Door

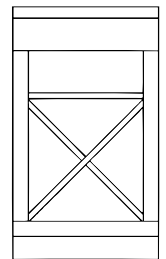
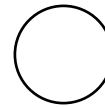

X-Style Wine Rack

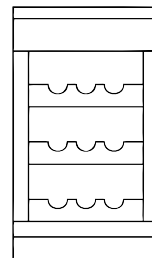
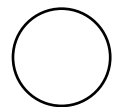

Bottle Cradle Rack

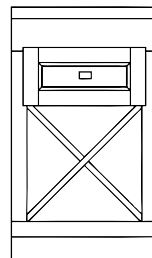
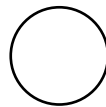

Drawer Over X-Rack

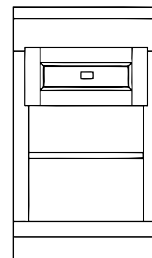
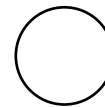

Drawer Over Shelf

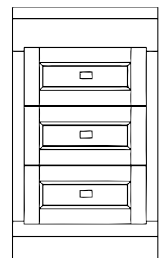
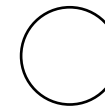

Three Drawers

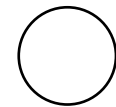

3. Select Other Options and Configurations:

- Refrigerator Bartender Left
- Refrigerator Bartender Right
- Flush-Cut Bartender Left
- Flush-Cut Bartender Right

- Black Laminate Bar Top
- Black Laminate Counter Top
- Raised Panels (N/A Rutherford)

- Brass Footrail
- Nickel Footrail
- Wood Footrail

4. Specify Finish:

Wood Finish Color: _____

Name: _____ City, State: _____

Phone Number: _____ Notes: _____