

# Build Your Own Bar System

## Walk-Up Wall Bars, Deluxe

Note: If matching with a Front Bar, subtract 16" from the width of the Front Bar, or 8" from a Flush-Cut Front Bar to find the width of the Walk Up Wall Bar.



### 1. Select Desired Style:



**M**  
Monroe



**N**  
Nassau



**R**  
Richmond

### 2. Select Desired Size & Options:

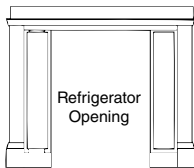

Refrigerator  
Opening

- 44"
- 50"

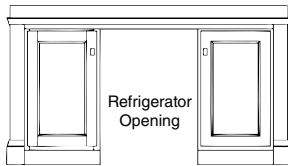

Refrigerator  
Opening

- 56"
- 62"
- 68"
- 74"
- 80"

**No Cabinet Options Available**

Note: Refrigerator Opening = 34.5"H x 24"W x 24"D

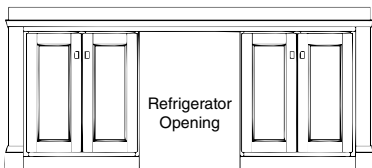

Refrigerator  
Opening

- 86"
- 92"
- 98"

### 3. Select Height

Other Options:

- Black Laminate Counter Top
- Raised Panels (N/A Rutherford)

### 4. Specify Finish:

Wood Finish Color: \_\_\_\_\_

Name: \_\_\_\_\_ City, State: \_\_\_\_\_

Phone Number: \_\_\_\_\_ Notes: \_\_\_\_\_