

# Build Your Own Bar System



## Return Bars, Standard Bartender Left Return

### 1. Select Desired Style:



**M**  
Monroe



**N**  
Nassau



**R**  
Richmond

### 2. Select Desired Size & Options:

### Cabinet Options

The line drawings to the left show letters inside circles indicating cabinet positions. If you would like one of the options shown below in the space marked with that letter, please write the letter in the circle beneath the pictured option. Note: Adjustable shelf is standard.

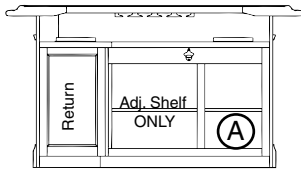

- 72"
- 78"
- 84"

OPTIONS: A Cabinet + Return

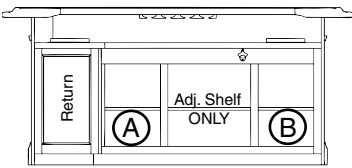

- 90"
- 96"
- 102"

OPTIONS: A & B Cabinets + Return

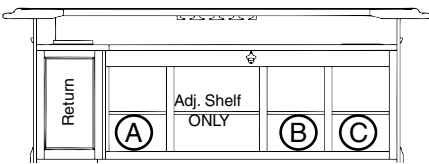

- 108"
- 114"

OPTIONS: A, B, & C Cabinets + Return



Return Options:  
AA & BB

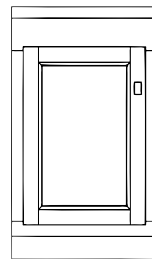

Non-Locking Door

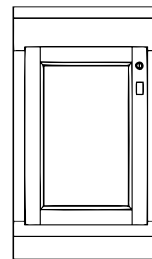
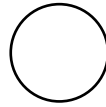

Locking Door

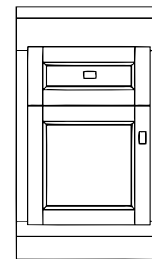
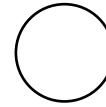

Drawer Over Door

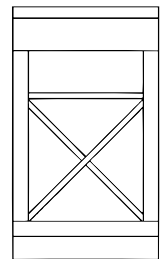
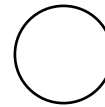

X-Style Wine Rack

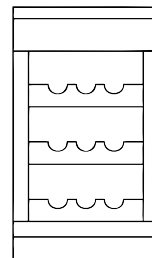
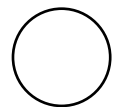

Bottle Cradle Rack

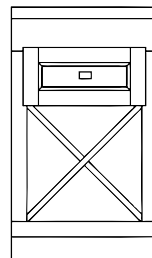
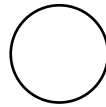

Drawer Over X-Rack

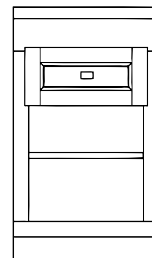
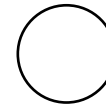

Drawer Over Shelf

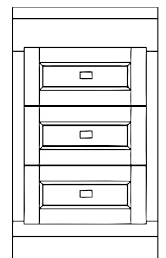
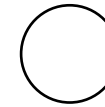

Three Drawers

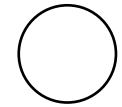

### 3. Select Other Options:

- Black Laminate Bar Top
- Brass Footrail
- Black Laminate Counter Top
- Nickel Footrail
- Raised Panels (N/A Rutherford)
- Wood Footrail

### 4. Specify Finish:

Wood Finish Color: \_\_\_\_\_

Name: \_\_\_\_\_ City, State: \_\_\_\_\_

Phone Number: \_\_\_\_\_ Notes: \_\_\_\_\_